

EN Built-in freezer

**EN IMPORTANT** - These instructions are for your safety. Please read through them thoroughly prior to handling the product and retain them for future reference.

**V21124\_5059340794037\_MAND2\_2324**

**GHBIFZUK**  
**5059340794037**  
**NNBITFRZUK**  
**5063022580467**

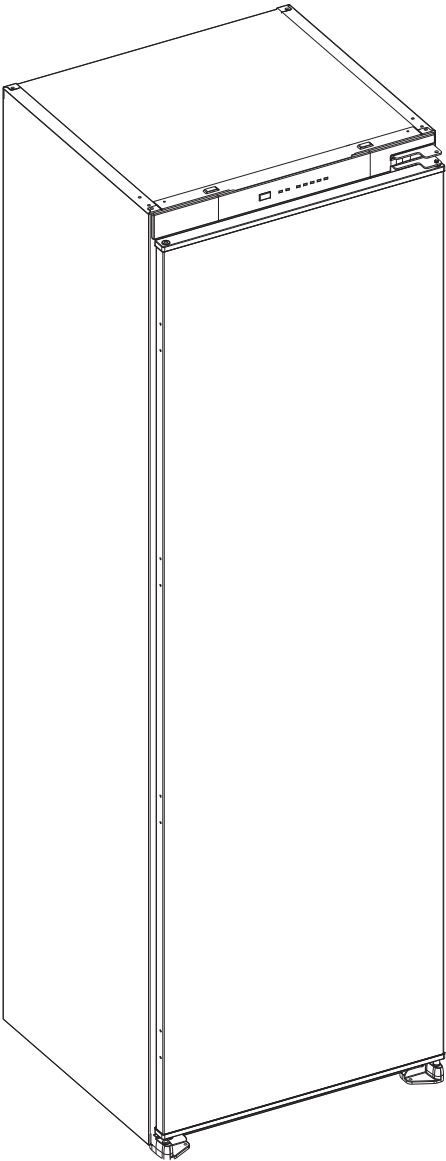

01. x1

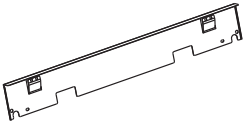

02. x1



03. x2



04. x17

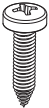

05. x4



06. x1

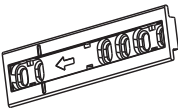

07. x4

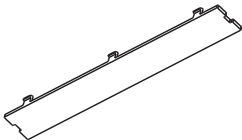

08. x4



09. x4

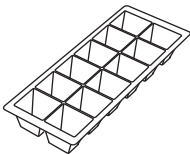

10. x1

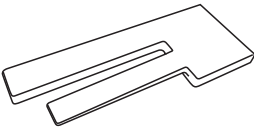

11. x1

**EN** Not included



**AA. x1**



**BB. x1**



**CC. x2**



**DD. x2**



**EE. x1**



**FF. x1**



**GG. x2**



**HH. x2**



**II. x1**



**JJ. x16**

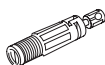

**KK. x12**



**LL. x16**

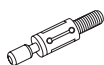

**MM. x4**



**NN. x76**

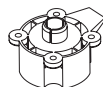

**PP. x4**

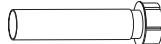

**QQ. x4**

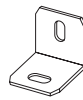

**RR. x2**

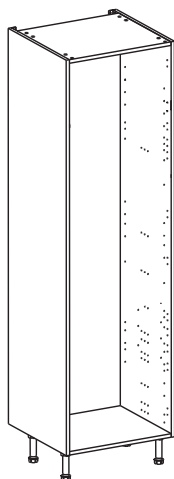

**EN** Standard Larder

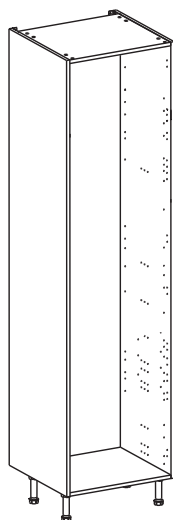

**EN** Tall Larder

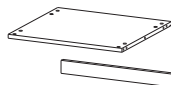

**EN** Appliance Shelf Pack

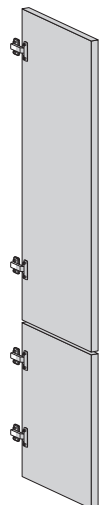
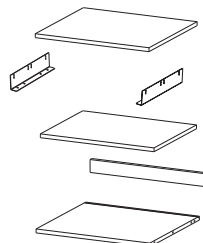

**EN** Decorative Doors

## EN You will need

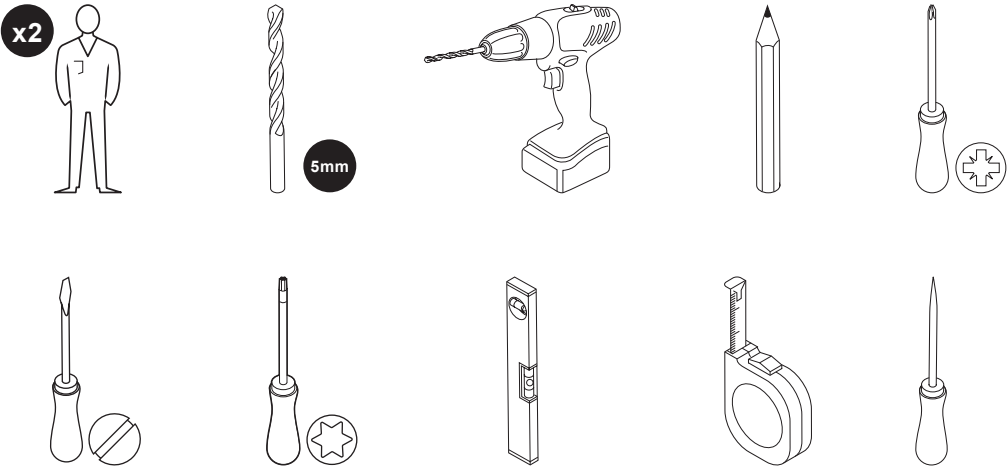

## EN Contents

EN	
Product description	5
Safety	6
Guarantee	10
Installation	11
Functions & Settings	35
Care & maintenance	36

EN Product description

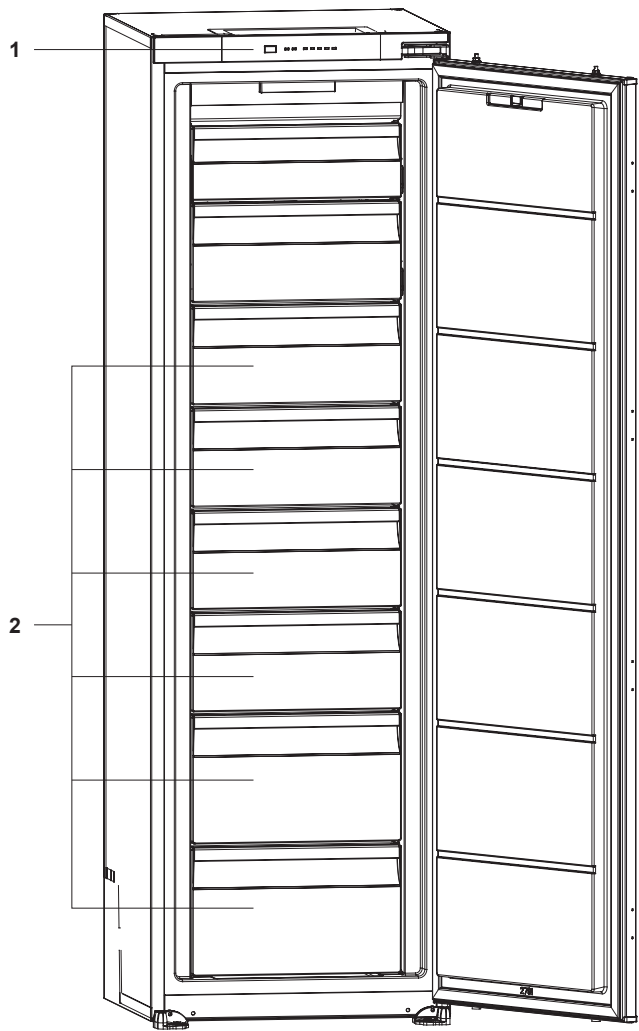

EN 1. Control panel 2. Freezer compartments



## EN Before you start

- These instructions are for your safety. Please read the following instructions and the sections of “Installation, Care and maintenance” carefully before proceeding with the installation and use of this appliance. Keep the instruction manuals for future reference.



**CAUTION: DO NOT OVERLOAD THE SHELVES AND FOLLOW THE MAXIMUM LOADING CAPACITY.**

- To avoid the risks that are always present when you use an electrical appliance it is important that this product is installed correctly and that you read the safety instructions carefully to avoid misuse and hazards. After unpacking the product please check that it is not damaged. If in doubt, do not use the appliance but contact Customer Services on 0330 678 3077 (UK) and 1800 365 800 (Eire).

- Check the package and make sure you have all of the parts listed and decide upon the appropriate location for your product.
- The specification plate shown on this appliance displays all the necessary identification information for ordering replacement parts and further information can be found at the end of this manual.
- If you sell the appliance, give it away, or leave it behind when you move house, please ensure that you pass on this manual so that the new owner can become familiar with the appliance and its safety warnings.



**WARNING: KEEP VENTILATION OPENINGS, IN THE APPLIANCE ENCLOSURE OR IN THE BUILT-IN STRUCTURE, CLEAR OF OBSTRUCTION.**



**WARNING:** DO NOT USE MECHANICAL DEVICES OR OTHER MEANS TO ACCELERATE THE DEFROSTING PROCESS, OTHER THAN THOSE RECOMMENDED BY THE MANUFACTURER.



**WARNING:** DO NOT DAMAGE THE REFRIGERANT CIRCUIT.



**WARNING:** DO NOT USE ELECTRICAL APPLIANCES INSIDE THE FOOD STORAGE COMPARTMENTS OF THE APPLIANCE, UNLESS THEY ARE OF THE TYPE RECOMMENDED BY THE MANUFACTURER.

- Do not store explosive substances such as aerosol cans with a flammable propellant in this appliance.



**WARNING:** WHEN POSITIONING THE APPLIANCE, ENSURE THE SUPPLY CORD IS NOT TRAPPED OR DAMAGED.



**WARNING:** DO NOT LOCATE MULTIPLE PORTABLE SOCKET-OUTLETS OR PORTABLE POWER SUPPLIES AT THE REAR OF THE APPLIANCE.

- This appliance can be used by children aged from 8 years and above and persons with reduced physical, sensory or mental capabilities or lack of experience and knowledge if they have been given supervision or instruction concerning use of the appliance in a safe way and understand the hazards involved. Children shall not play with the appliance. Cleaning and user maintenance shall not be made by children without supervision.

- Children aged from 3 to 8 years are allowed to load and unload refrigerating appliances.
- This appliance is for domestic household use only.



**WARNING: DO NOT BLOCK ANY VENTILATION GRILLS AND ENSURE THERE IS SUFFICIENT AIRFLOW AT THE REAR OF THE APPLIANCE.**

- Before cleaning always unplug the appliance from the mains supply.
- A steam cleaner should never be used to clean the appliance.
- If the supply cord is damaged, it must be replaced by the manufacturer, its service agent or similarly qualified persons in order to avoid a hazard.
- Repairs should only be made by an authorized service engineer using genuine replacement spares. Repairs by non-authorized engineers could invalidate your guarantee. Contact the Customer Service helpline at the end of this manual for assistance.
- Connection to the mains supply should not be made with an extension cord.
- Do not allow children to play inside or with the door of this appliance to avoid possible toppling over of the appliance and injury.
- Do not allow children access to the front grill or rear compressor department of this appliance to avoid possible injury.
- Do not attempt to repair this appliance yourself, there are no user serviceable parts inside. In the event of a malfunction, contact the Customer Service helpline at the end of this manual.
- Dispose of all packaging materials safely and responsibly.
- Care should be taken when handling or transporting the product to prevent damaging the refrigerating circuit or components.





**WARNING: THIS PRODUCT USES ISOBUTANE R600A REFRIGERANT, WHICH CAN BE FLAMMABLE OR EXPLOSIVE. REPAIRS AND DISPOSAL MUST ALWAYS BE CARRIED OUT BY A R600A QUALIFIED ENGINEER.**

- Care should be taken when handling or transporting the product to prevent damaging the refrigerating circuit or components.
- This product should be placed at least 10 cm from stoves, ovens and other heating appliances.
- Do not place the product on a carpeted surface as this will prevent adequate ventilation.
- This appliance must be installed in a larger cabinet.
- Choose a dry and well ventilated space for installation.

- To avoid contamination of food, please respect the following instructions:
  - Opening the door for long periods can cause a significant increase of the temperature in the compartments of the appliance.
  - Clean regularly surfaces that can come in contact with food and accessible drainage systems.
  - Store raw meat and fish in suitable containers in the refrigerator, so that it is not in contact with or drip onto other food.
  - If the refrigerating appliance is left empty for long periods, switch off, defrost, clean, dry, and leave the door open to prevent mould developing within the appliance.



**WARNING:  
RISK OF FIRE /  
FLAMMABLE  
MATERIALS**



**WARNING: THE BULB SHALL BE REPLACED BY QUALIFIED TECHNICIAN, CONTACT THE CUSTOMER SERVICE HELPLINE FOR ASSISTANCE.**

## **Guarantee**

We take special care to select high quality materials and use manufacturing techniques that allow us to create products incorporating design and durability. This refrigerator has a manufacturer's guarantee of 2 years against manufacturing defects, from the date of purchase (if bought in store) or date of delivery (if bought online), at no additional cost for normal (non-professional or commercial) household use.

To make a claim under this guarantee, you must present your proof of purchase (such as a sales receipt, purchase invoice or other evidence admissible under applicable law), please keep your proof of purchase in a safe place. For this guarantee to apply, the product you purchased must be new, it will not apply to second hand or display products. Unless stated otherwise by applicable law, any replacement product issued under this guarantee will only be guaranteed until expiry of the original period guarantee period.

This guarantee covers product failures and malfunctions provided the product was used for the purpose for which it is intended and subject to installation, cleaning, care and maintenance in accordance with the information contained in these terms and conditions, in the user manual and standard practice, provided that standard practice does not conflict with the user manual.

This guarantee does not cover defects and damage caused by normal wear and tear or damage that could be the result of improper use, faulty installation or assembly, neglect, accident, misuse, or modification of the product.

Unless stated otherwise by applicable law, this guarantee will not cover, in any case, ancillary costs (shipping, movement, costs of uninstalling and reinstalling, labour etc), or direct and indirect damage.

If the product is defective, we will, within a reasonable time, repair.

Rights under this guarantee are enforceable in the country in which you purchased this product. Guarantee related queries should be addressed to the store you purchased this product from.

The guarantee is in addition to and does not affect your statutory rights.

**IMPORTANT - RETAIN THIS INFORMATION FOR FUTURE REFERENCE: READ CAREFULLY**

---

### Before you start

This appliance must be installed correctly by a qualified person, strictly following the manufacturer's instructions.



**WARNING: DANGER OF ELECTRIC SHOCK! THE POWER SUPPLY MUST BE CUT OFF BEFORE THE APPLIANCE IS INSTALLED COMPLETELY.**

- Only a qualified person in compliance with the instructions provided can install the appliance. The manufacturer declines all responsibility for improper installation, which may harm persons and animals and cause damage.
- Check the package and make sure you have all of the parts listed.
- Decide on the appropriate location for the appliance.
- This appliance contains glass. Please take care when fitting or handling to prevent personal injury or damage to the appliance.
- The specifications plate is available on this appliance. This plate displays all the necessary identification information for ordering replacement parts.
- If you sell the appliance, give it away, or leave it behind when you move house, please ensure you pass on this set of instructions.

### Safety



**WARNING: IN ORDER TO PREVENT OVERTURNING THIS APPLIANCE MUST BE INSTALLED IN AN APPLIANCE LARDER CABINET AND MUST BE USED WITH THE WALL BRACKETS SUPPLIED WITH THE CABINET.**



**WARNING: INSTALLATION MUST BE PERFORMED BY A COMPETENT PERSON ONLY. THIS PRODUCT COULD BE DANGEROUS, CAUSE INJURY OR DAMAGE TO PROPERTY IF INCORRECTLY INSTALLED.**

- Some parts could be hazardous to small children.
- Keep all parts out of reach and do not leave children unattended in the assembly area.
- Serious or fatal crushing injuries can occur from furniture tip-over.

To prevent this furniture from tipping over it must be permanently fixed to the wall. Fixing devices for the wall are not included since different wall materials require different types of fixing devices. Use fixing devices suitable for the walls in your home.

- Prevent children from climbing or hanging on the drawers, doors or shelves.
- If you are in any doubt as to how to install this product, consult a technically competent person.



**CAUTION: ALWAYS ENSURE THE PRODUCT IS SECURELY FITTED BEFORE USE.**

### IMPORTANT RETAIN THIS INFORMATION FOR FUTURE REFERENCE: READ CAREFULLY.

All parts and full details on how to assemble your appliance larder cabinet are supplied with the appliance shelf pack.

## Assembly Procedure

- A) Confirm your larder height from either standard or tall.
- B) Decide on your appliance door opening direction and change it if required.
- C) Build the cabinet and attach the hinges and decorative doors. Secure the cabinet to the wall.
- D) Locate the appliance within the cabinet and secure the fridge to the cabinet.

Before connecting the mains supply ensure that the mains voltage corresponds to the voltage on the rating plate.

## Direct Connection

- The appliance is supplied with a fitted plug suitable for use in your country.
- Do not bend the cable or compress it under a heavy load.
- Regularly check the power cord for damage. If the supply cord becomes damaged, it must be replaced by the manufacturer, its service agent or similarly qualified persons in order to avoid a hazard. Contact the Customer Service helpline at the end of this manual.



**WARNING:** THIS IS A CLASS I APPLIANCE AND MUST BE EARTHED.

## Technical data

Power supply voltage	220-240 V
Frequency (Hz)	50 Hz
Refrigerant / weight	R-600a Isobutane / 44 g
Rated current (A)	1.16 A
Power consumption (W)	168 W

Supplier's name or trade mark: Kingfisher Int. Prod. Ltd., Kingfisher Int. Prod. B.V.				
Supplier's address <sup>(b)</sup> : UK Manufacturer: Kingfisher International Products Limited, 1 Paddington Square, London, W2 1GG, United Kingdom. EU Manufacturer: Kingfisher International Products B.V., Rapenburgerstraat 175E, 1011 VM Amsterdam, The Netherlands.				
Model identifier: NNBITFRZUK / GHBITFZUK				
Type of refrigerating appliances:				
Low-noise appliance:		No	Design type:	Built-in
Wine storage appliance:		No	Other refrigerating appliances:	Yes
General product parameters:				
Parameter		Value	Parameter	Value
Overall dimensions (millimeter)	Height	1770	Total volume (L)	196
	Width	540		
	Depth	545		
EEI		100 %	Energy efficiency class	E
Airborne acoustical noise emissions (dB(A) re 1 pW)		40	Airborne acoustical noise emission class	C
Annual energy consumption (kWh/a)		231	Climate class:	SN/N/ST/T
Minimum ambient temperature (°C), for which the refrigerating appliance is suitable		10 °C	Maximum ambient temperature (°C), for which the refrigerating appliance is suitable	43 °C

Winter setting		No			
<b>Compartment Parameters:</b>					
Compartment type		Compartment parameters and values			
		Com-partment Volume (dm <sup>3</sup> or l)	Recommended temperature setting for optimised food storage (°C)	Freezing capacity (kg/24 h)	Defrosting type (auto-defrost = A, manual defrost = M)
			These settings shall not contradict the storage conditions set out in Annex IV, Table 3		
Pantry	No	—	—	—	—
Wine storage	No	—	—	—	—
Cellar	No	—	—	—	—
Fresh food	Yes	—	—	—	—
Chill	No	—	—	—	—
0-star or ice-making	No	—	—	—	—
1-star	No	—	—	—	—
2-star	No	—	—	—	—
3-star	No	—	—	—	—
4-star	Yes	196.6	≤ -18	11.5	A
2-star section	No	—	—	—	—
Variable temperature compartment	No	—	—	—	—
<b>For 4-star compartments</b>					
Fast freeze facility			Yes		
<b>For wine storage appliances</b>					
Number of standard wine bottles			-		
<b>Light source parameters:</b>					
Type of light source			LED		
Energy efficiency class			F		
<b>Minimum duration of the guarantee offered by the manufacturer <sup>(b)</sup>: 24</b>					
<b>Additional information:</b> EN 60704-2-14/EN 60704-3					
Weblink to the manufacturer's website, where the information in point 4 (a) Annex of Commission Regulation (EU) 2019/2019 (1) (b) is found:					
(a) As determined in accordance with Commission Delegated Regulation (EU) 2019/2015 (2).					
(b) Changes to these items shall not be considered relevant for the purposes of point 4 of Article 4 of Regulation (EU) 2017/1369.					
(c) If the product database automatically generates the definitive content of this cell the supplier shall not enter these data.					
(d) This item shall not be considered relevant for the purpose of Article 2(6) of Regulation (EU) 2017/1369.					

Technical parameters of the model and their declared values for refrigerating appliances			
A general description of the refrigerating model, sufficient for it to be unequivocally and easily identified:			
Product specifications:			
General product specifications:			
Parameter	Value	Parameter	Value
AE_Annual energy consumption (kWh/a)	231	EEl (%)	100
SAE_Standard annual energy consumption (kWh/a)	231.4	Combi parameter ©	1.00
Temperature rise time (h)	6	Load factor (L)	0.9
Door heat loss factor (D)	1.000	Climate class:	SN/N/ST/T
Anti-condensation heater type	None	Airborne acoustical noise emissions (dB(A) re 1 pW)	40
Additional product specifications for refrigerating appliances, except for low noise refrigerating appliances:			
Parameter	Value		
Daily energy consumption at 32 °C (kWh/24h)	0.739		
Additional product specifications for low noise refrigerating appliances:			
Parameter	Value		
Daily energy consumption at 25 °C (kWh/24h)	-		
Additional product specifications for wine storage appliances:			
Parameter	Value	Parameter	Value
Internal humidity (%)	-	Number of bottles	-

Compartment specifications:								
Compartment type	Compartment parameters and values							
	Target temperature (°C)	Compartment volume (dm <sup>3</sup> or l)	Freezing capacity (kg/24 h)	Thermo-dynamic parameter (rc)	Nc	Mc	Defrost factor (Ac)	Built-in factor (Bc)
Pantry	17							
Wine storage	12							
Cellar	12							
Fresh food	4							
Chill	2							
0-star or ice making	0							
1-star	-6							
2-star	-12							
3-star	-18							
4-star	-18	196.6	11.5	0.35	75	0.12	1.00	
2-star section	-12							
Variable temperature compartment								
The sum of the volumes of the chill compartment(s) and the unfrozen compartment(s) (l or dm <sup>3</sup> )								
The sum of the volumes of the frozen compartment(s) (l or dm <sup>3</sup> )		196						

#### NOTES:

1. This appliance is designed to be used within an ambient temperature range of 10 °C to 43 °C. (Climate Class: Sub-Normal SN, Normal N, Sub-Tropical ST, Tropical T).

According to EU regulation 2019/2016. Information can also be found at the website:  
[www.kingfisher.com/products](http://www.kingfisher.com/products)

## Troubleshooting

### Warning LED

In the event of a malfunction with your appliance, an LED in the control panel will illuminate red.

This may illuminate after first turning on, or after an extended power cut. If the LED is still lit after one hour of normal operation, please contact the Customer Service number for your country found at the end of this manual for assistance.

### Recycling & disposal



This symbol is known as the 'Crossed-out Wheeled Bin Symbol'. When this symbol is marked on a product or battery, it means that it should not be disposed of with your general household waste. Some chemicals contained within electrical/electronic products or batteries can be harmful to health and the environment. Only dispose of electrical/ electronic/battery items in separate collection schemes, which cater for the recovery and recycling of materials contained within. Your co-operation is vital to ensure the success of these schemes and for the protection of the environment.

### Safety Regulations



**WARNING:** THIS APPLIANCE IS DESIGNED FOR THE STORAGE OF FOOD AND BEVERAGES ONLY. DO NOT STORE ANY OTHER MATERIALS IN THIS APPLIANCE.

### Availability of Spare Parts

Dependent upon the spare part, these are available for a minimum period of seven years for professional repairers or a minimum of ten years for professional repairers and end-users. Contact the Customer Service helpline for assistance or visit:

[www.kingfisherspares.com](http://www.kingfisherspares.com)

For assistance, contact the Customer Services helpline:

UK 0330 678 3077 [uk@kingfisherservice.com](mailto:uk@kingfisherservice.com)

Eire 1800 365 800 [eire@kingfisherservice.com](mailto:eire@kingfisherservice.com)

Further information about this appliance can also be found at:

[www.kingfisher.com/products](http://www.kingfisher.com/products)



# 01

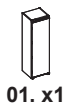

01. x1

## Door Reversal

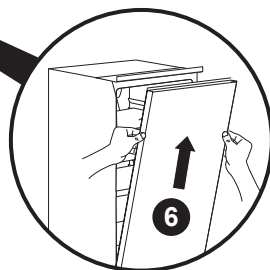
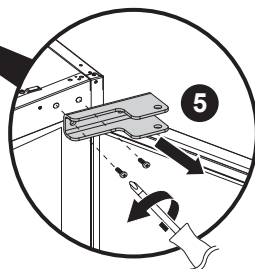
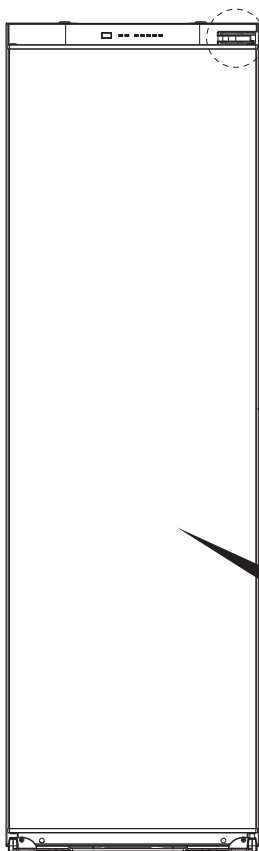
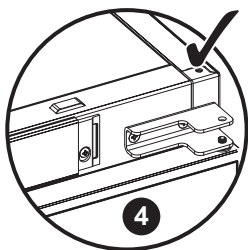
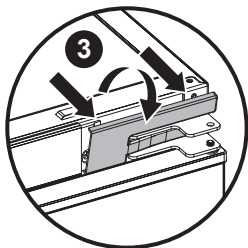
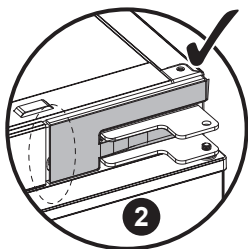
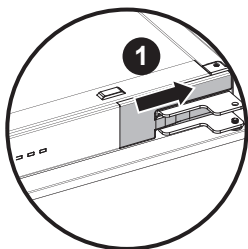

**EN IMPORTANT:** Complete this before installation into the cabinet.

Carefully remove the two plastic hinge covers with a flat screwdriver. Unscrew the upper door hinge and carefully remove the door.

# 02

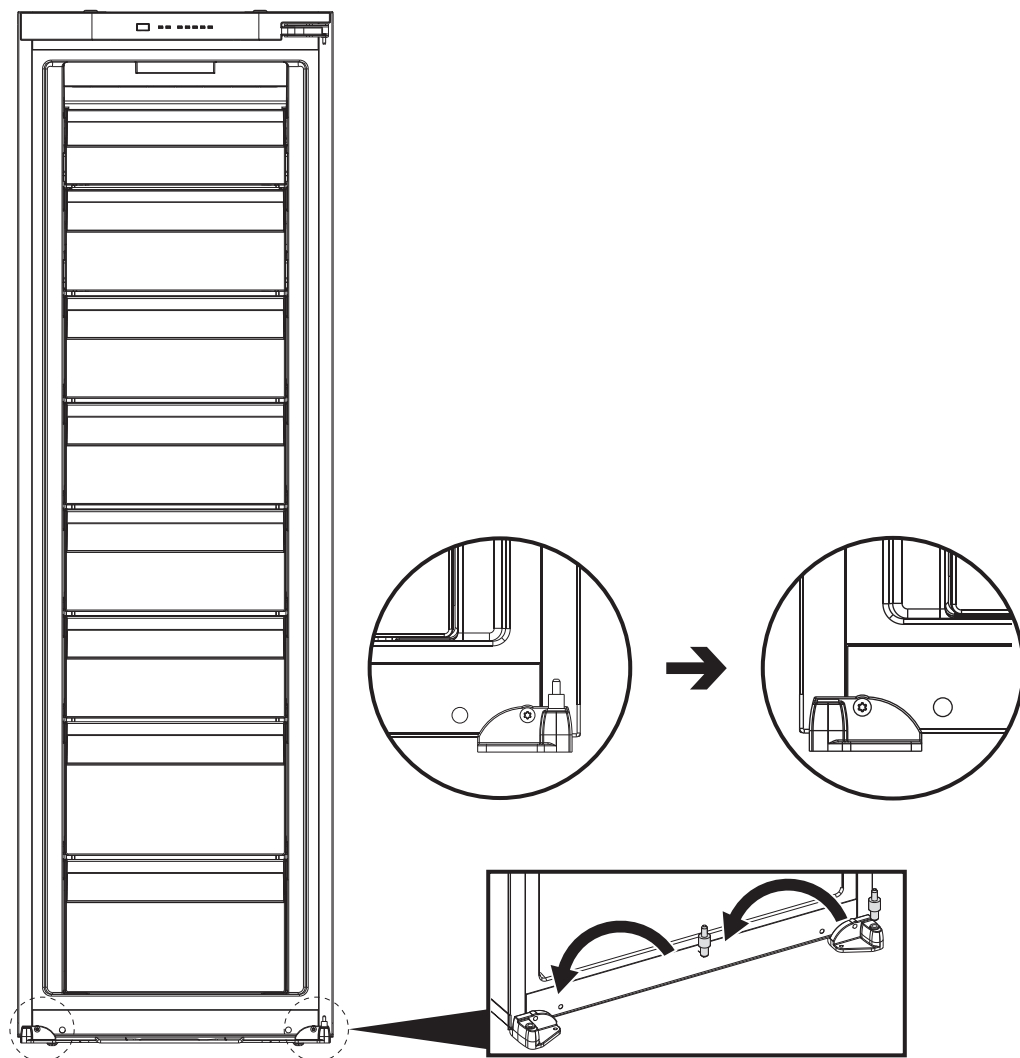

**EN** Move the bottom hinge pin from the right side to the left side.

# 03

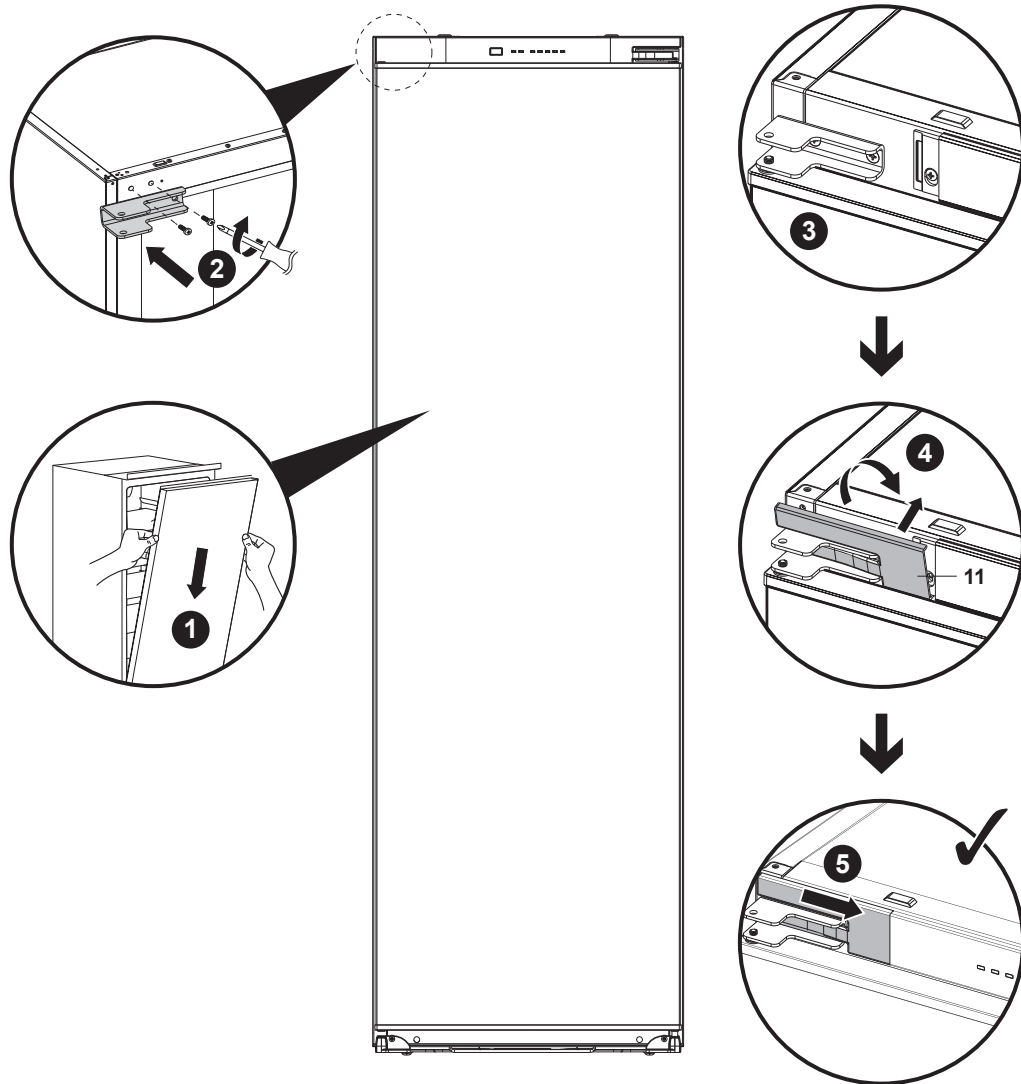
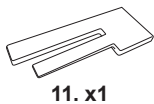

- EN**
- Relocate the door onto the bottom hinge and reattach the top hinge on the left.
  - Replace the plastic hinge covers and ensure the door is correctly aligned with the cabinet and fully closes without issue.

# 04

## Cabinet Assembly

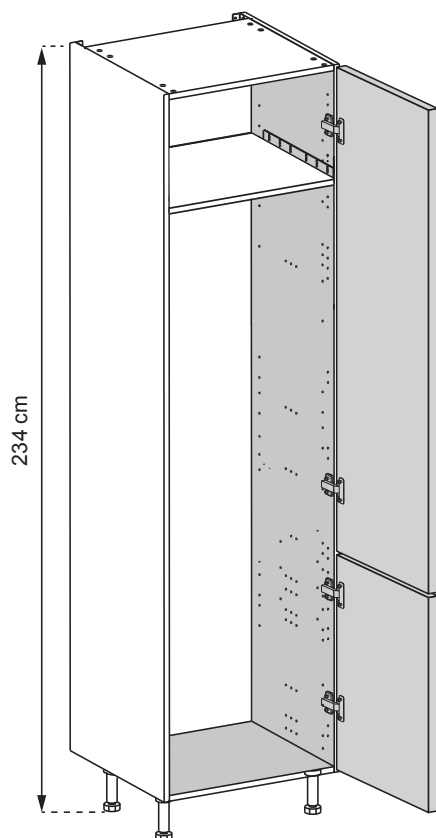

**EN** Tall (234 cm including legs)

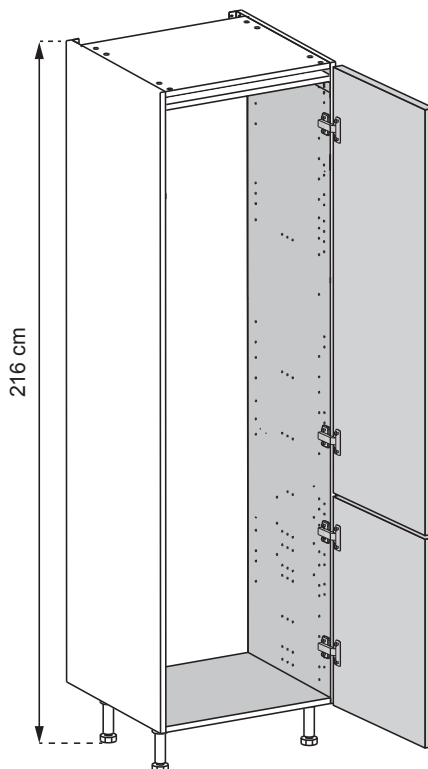

**EN** Standard (216 cm including legs)

### **EN** Positioning the appliance

For correct installation, this appliance must be fitted in an appliance larger cabinet.

- Remove all packaging before use and dispose of responsibly.
- Do not use outside or in a wet location.
- Do not locate the appliance in direct sunshine or near to heat sources.
- Do not tilt the appliance by more than 45° during installation.
- This appliance is designed to be operated between ambient temperatures of 16°C to 43°C. (Climate Class: Normal N, Sub-Tropical ST, Tropical T).
- Do not install in a garage or outhouse where the ambient temperatures may exceed this range.
- Ensure there is sufficient ventilation at the rear of the appliance to ensure correct operation. Inadequate ventilation can affect adjacent cabinets due to a rise in temperature.

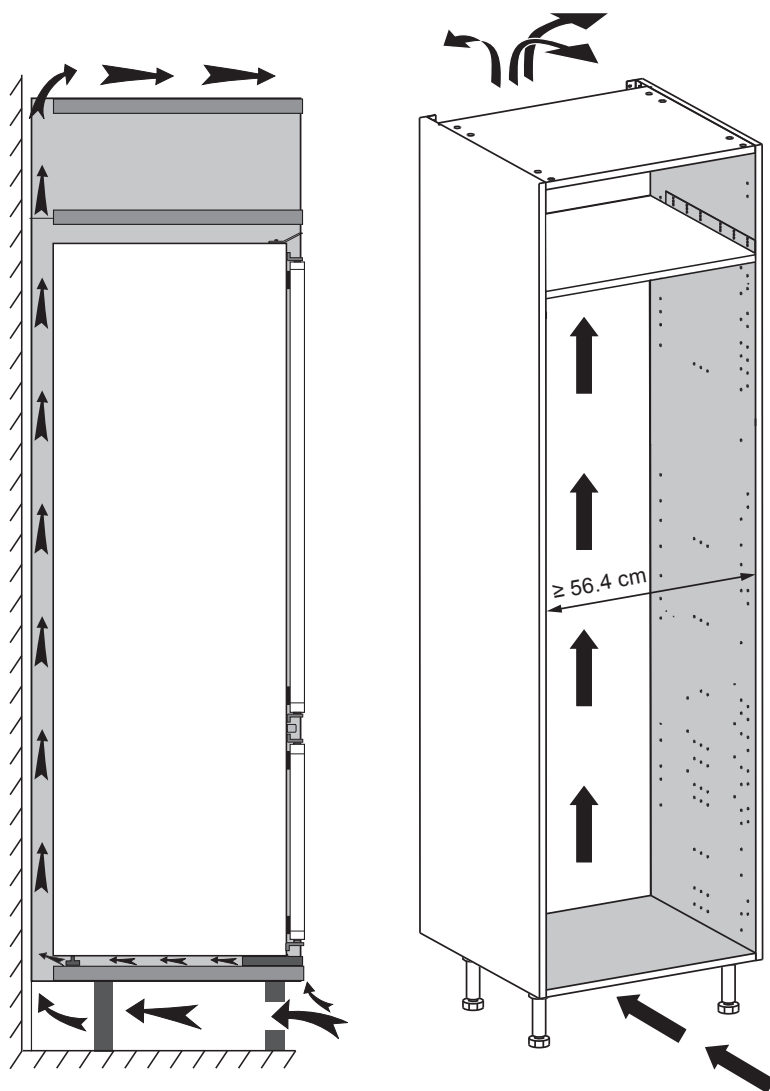

**EN** The diagram above shows the air circulation requirements including a slot that should be cut into the plinth if fitted. The back panel of the cabinet is not installed during assembly.

It is essential when installing your fridge there is adequate air circulation around the appliance to ensure the correct operation of the appliance. Inadequate air circulation will greatly impair the performance of the appliance and can affect adjacent cabinets due to the rise in temperature.

# 06

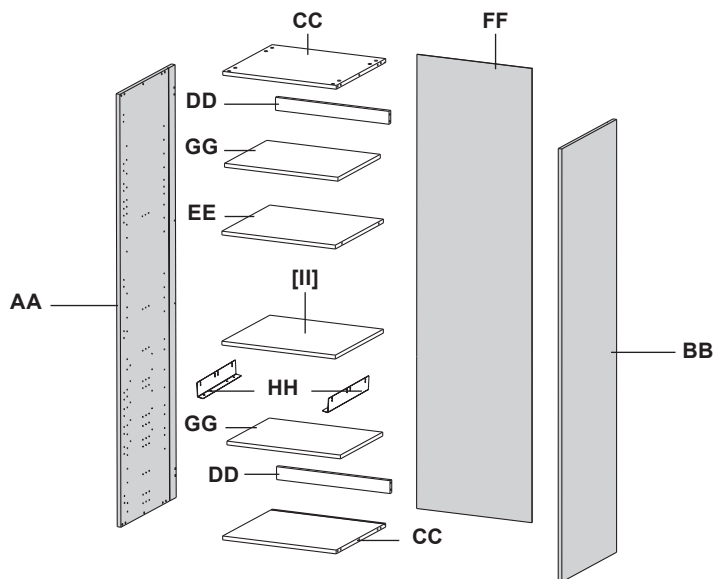

# 07

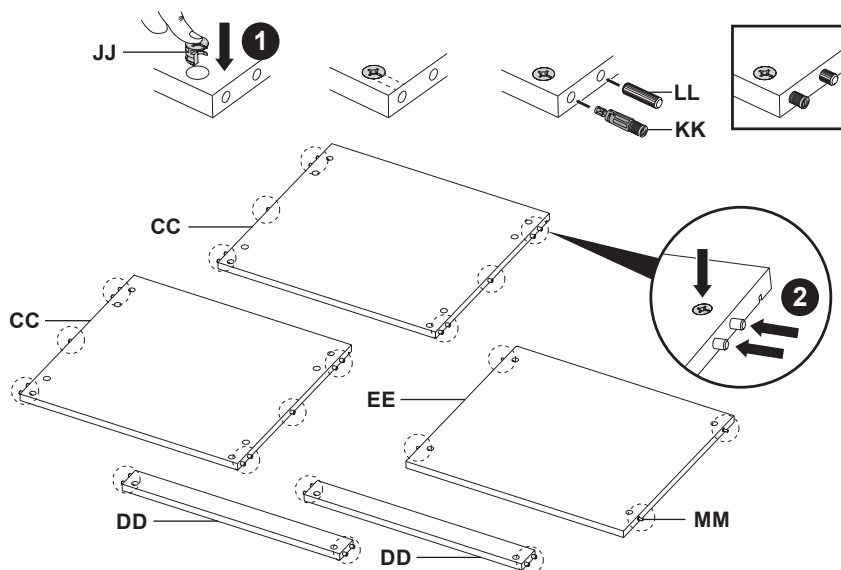

08

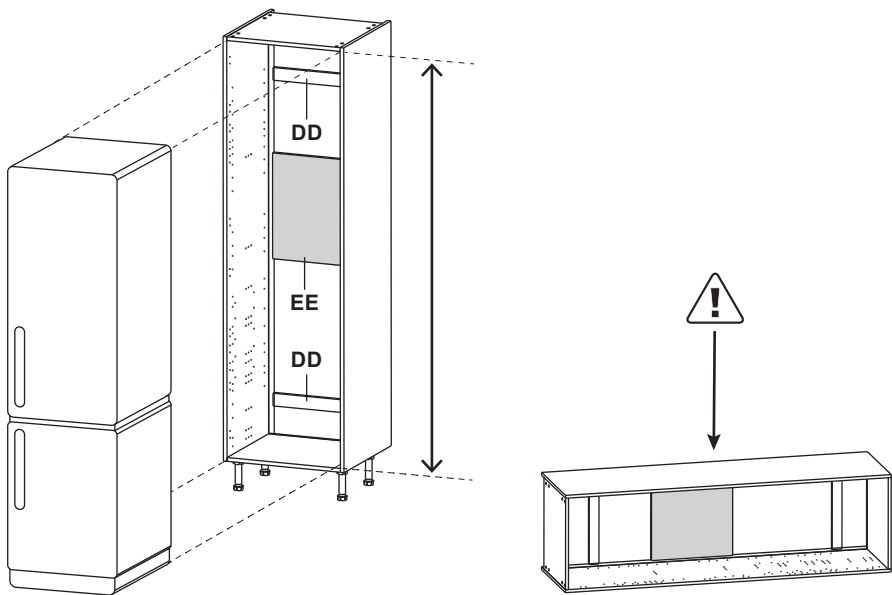

09

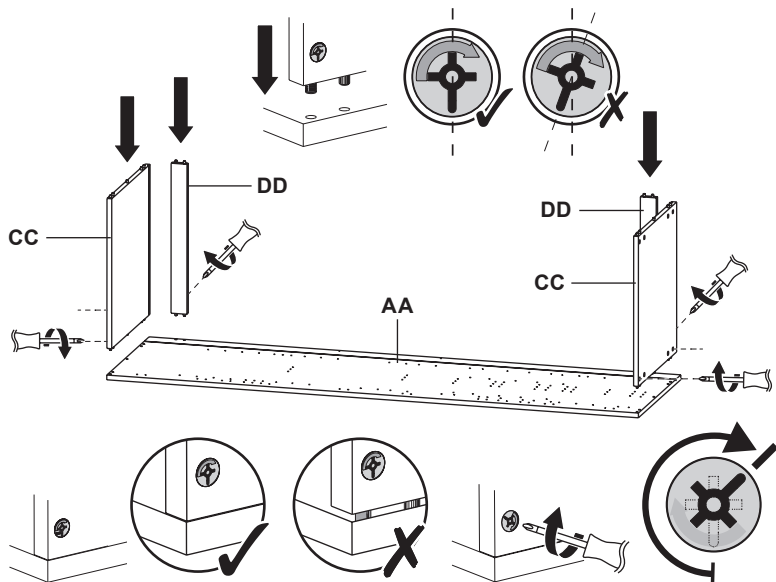

# 10

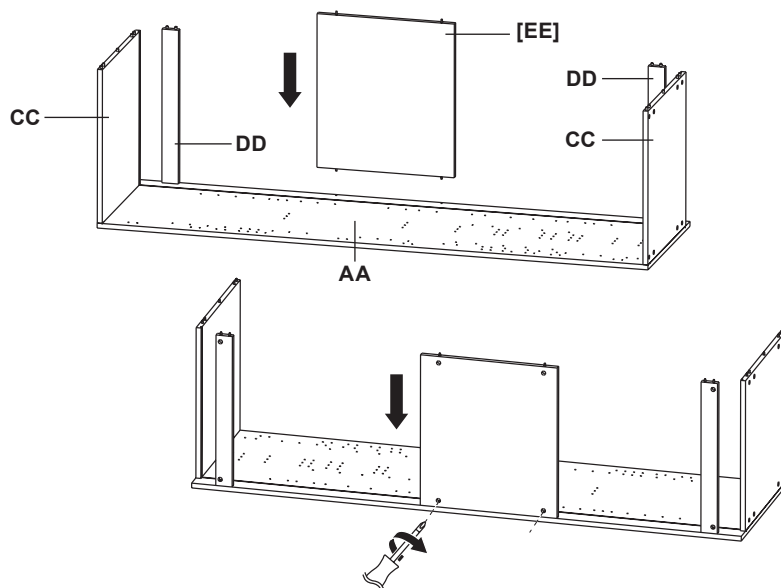

# 11

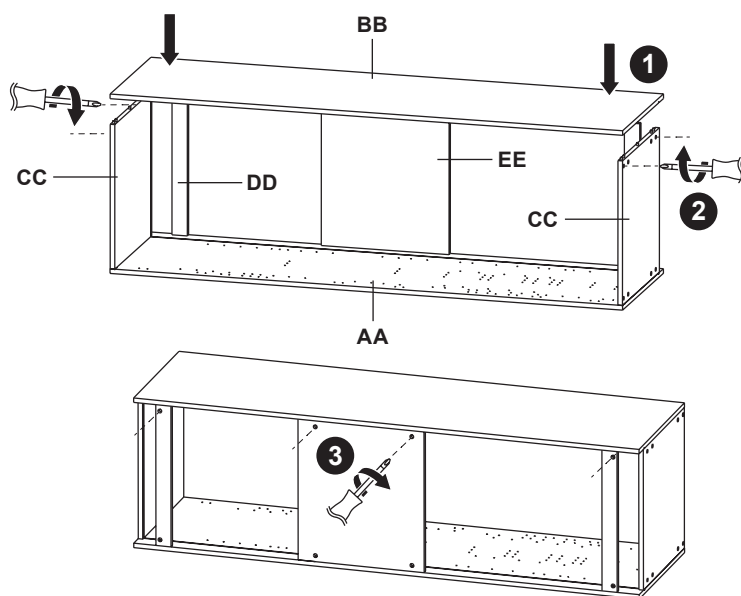



# 12

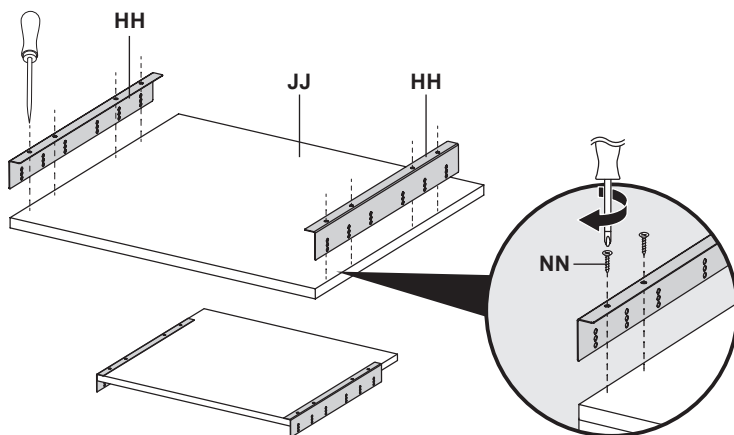

# 13A

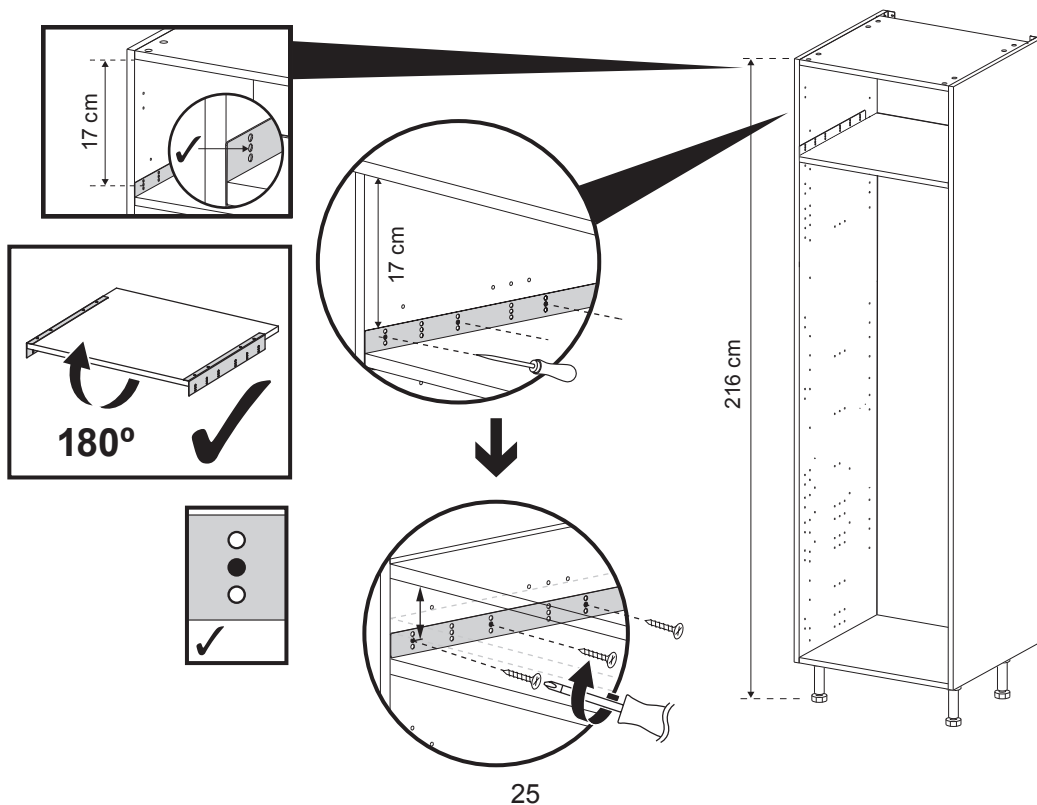

# 13B

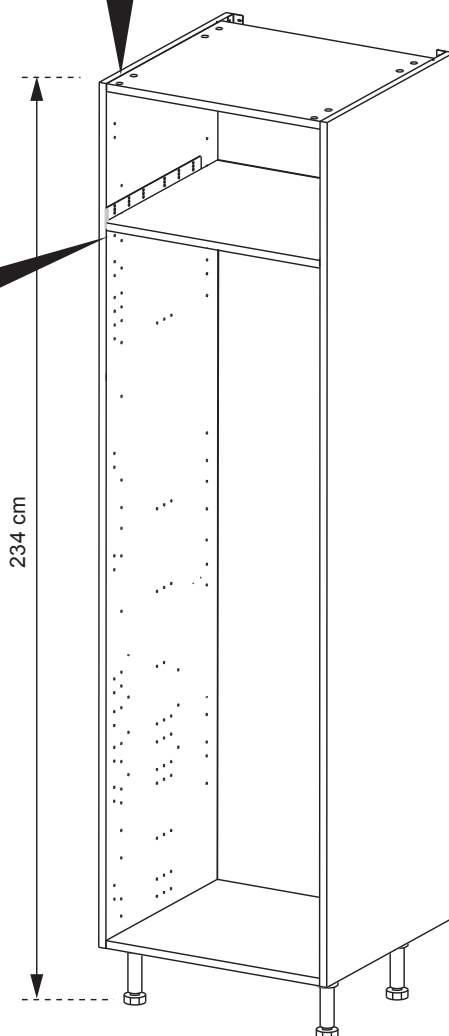
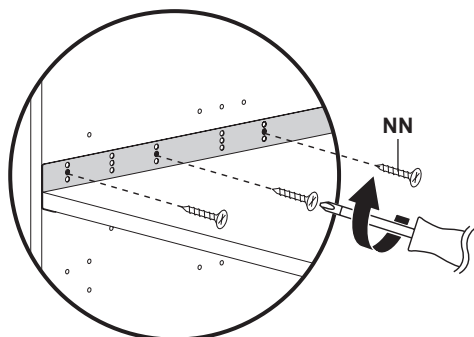
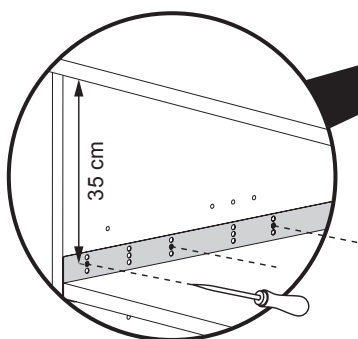
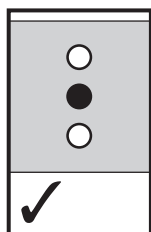
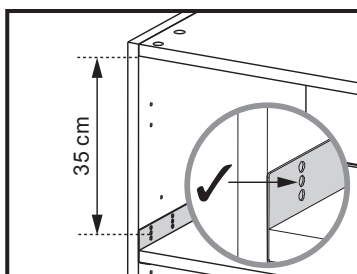
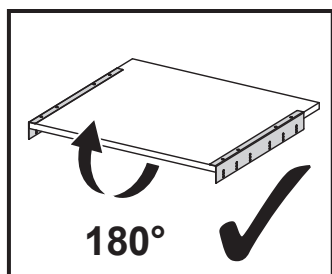

# 14

NN. x66

PP. x4

QQ. x4

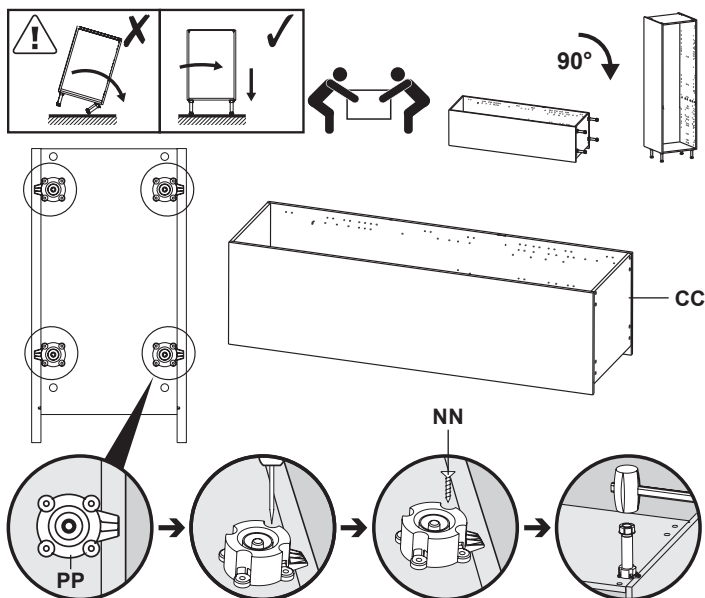

# 15

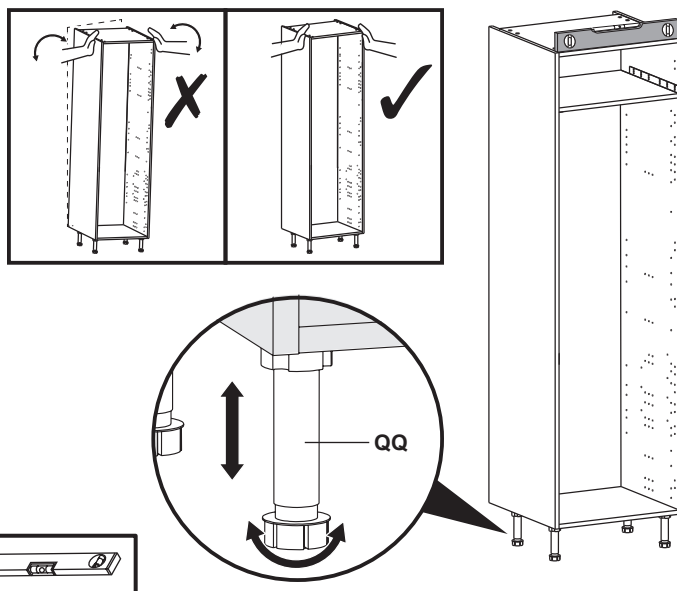

# 16

  
 NN. x2

  
 RR. x2

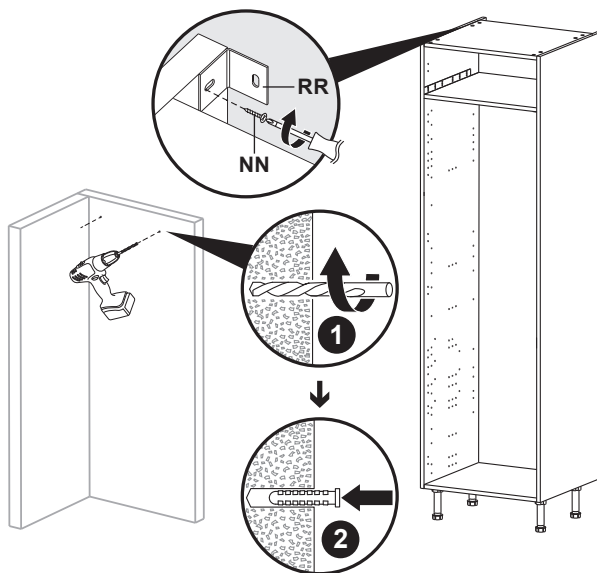

# 17

  
 NN. x2

  
 RR. x2

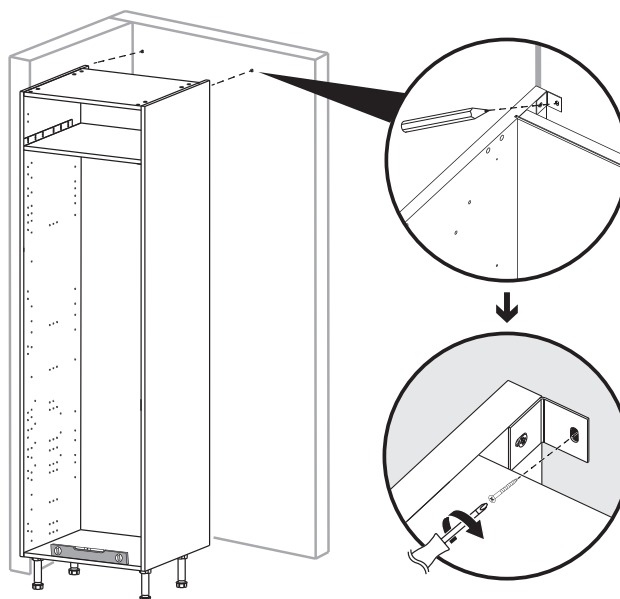

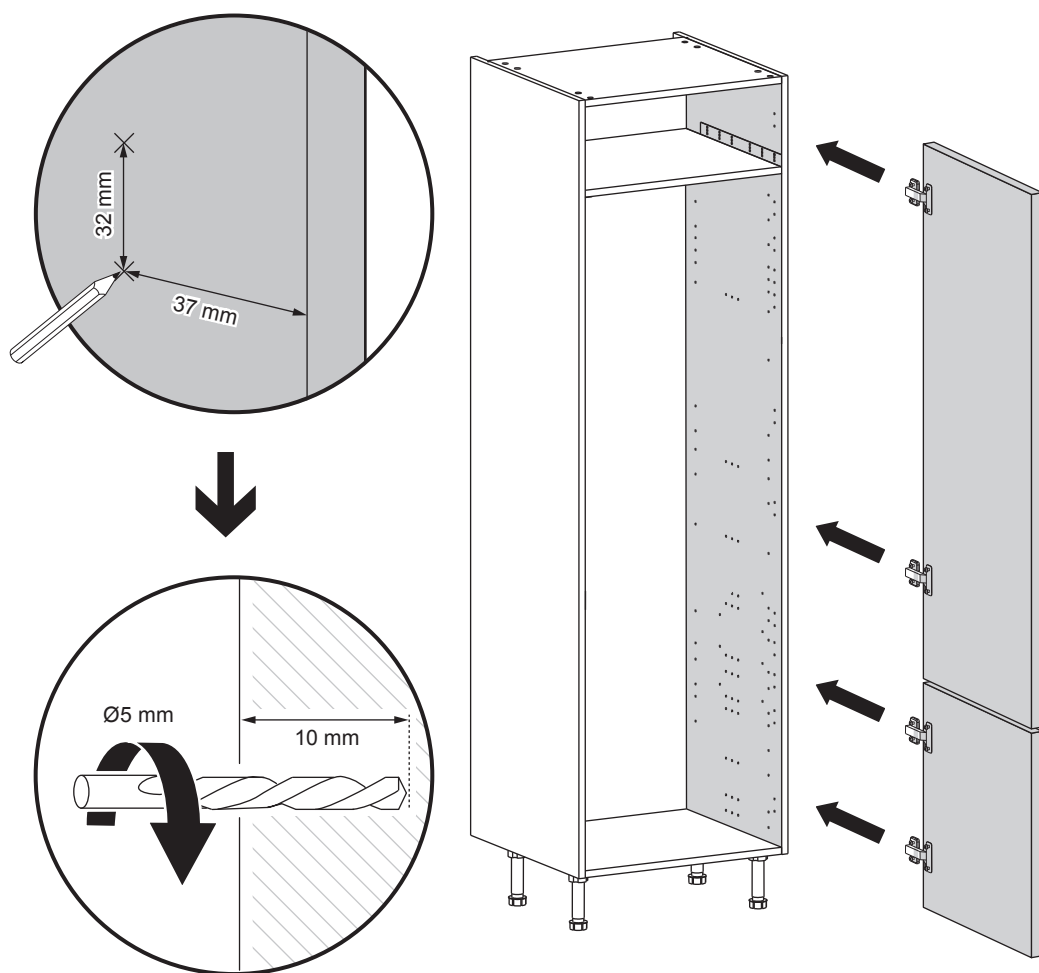

## EN IMPORTANT

- You will need to add hinges and doors before inserting the appliance into the cabinet.
- Dependant upon your chosen door configuration, you may need to add extra screw holes to the vertical cabinet panels to fix all of the hinges.
- Any extra holes will need to be drilled using a 5 mm drill bit and will be centred at 37 mm from the front cabinet edge and 32 mm apart.

# 19



02. x1



03. x2



06. x1

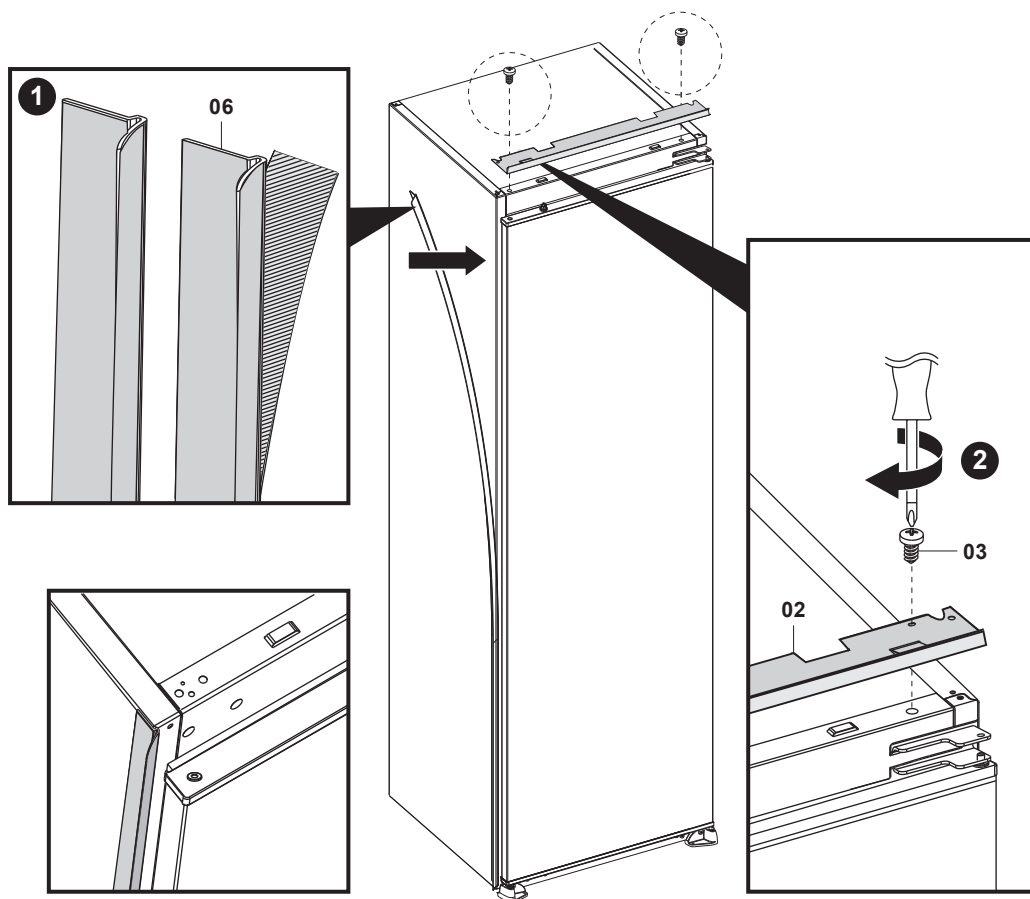

- EN**
- Add the sealing strip 06. x1 to the edge of the carcass opposite to the hinges before the appliance is installed into the cabinet.
  - Fix the roof bar 02. x1 with the two screws 03. x2.

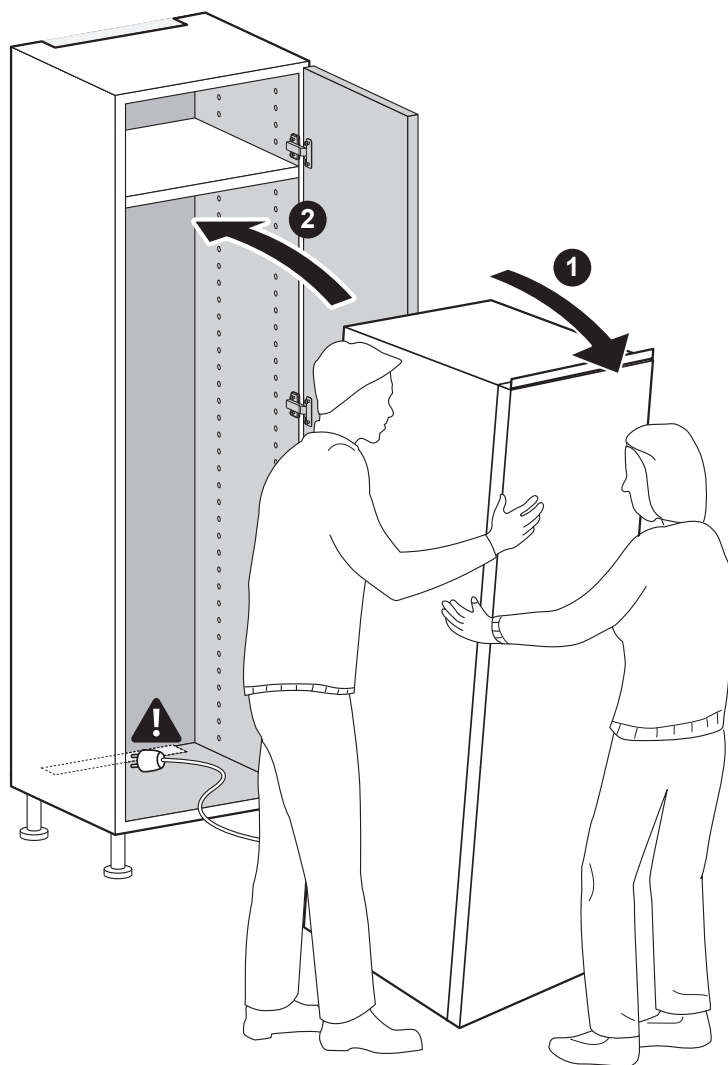

**EN WARNING:** Do not locate multiple portable socket-outlets or portable power supplies at the rear of the appliance.

**CAUTION:** Connect the mains plug to the mains socket only at the end of the installation. Make sure that there is access to the mains plug after the installation.

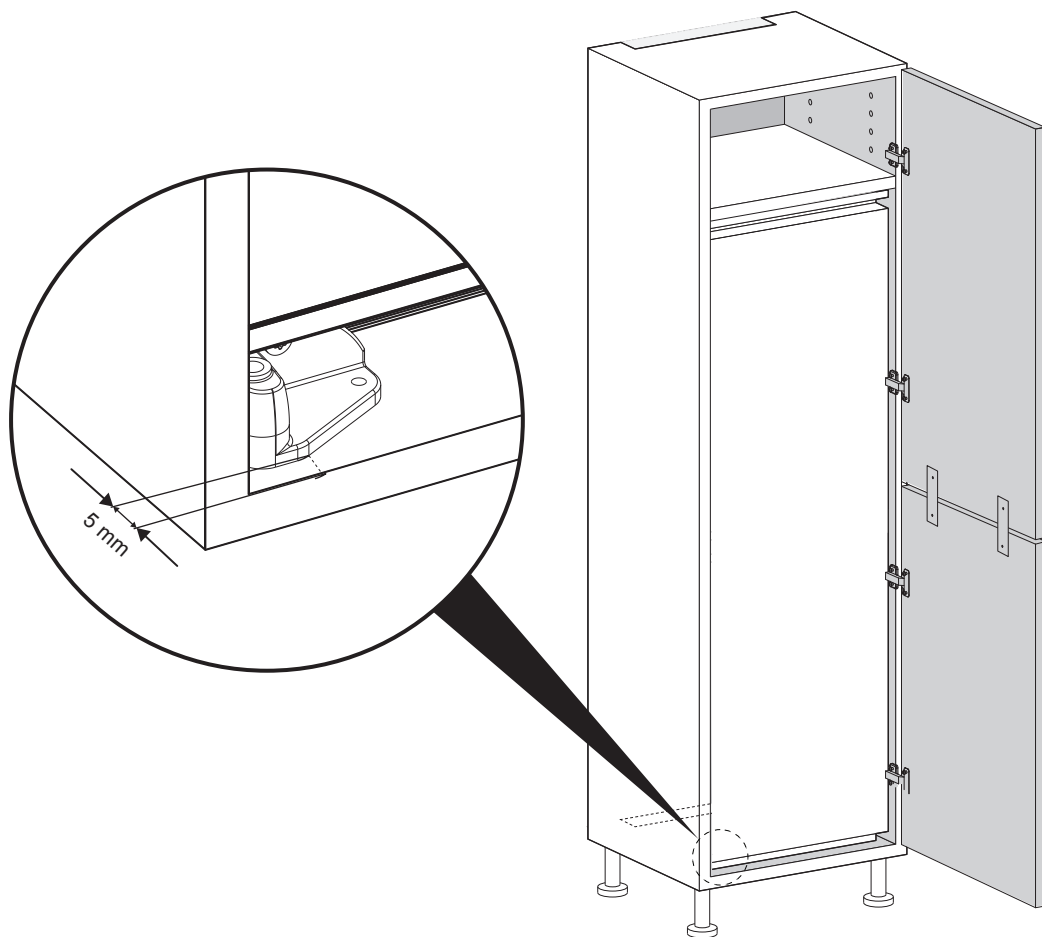

- EN**
- Move the appliance so that the front face of the roof bar is level with the cabinet front sides.
  - Ensure that the front face of the appliance is vertical and the feet should now be aligned as close to the bottom face as possible, to a maximum of 5 mm.
  - Ensure the appliance is sited so that the door sliders and hinges do not catch the carcass.



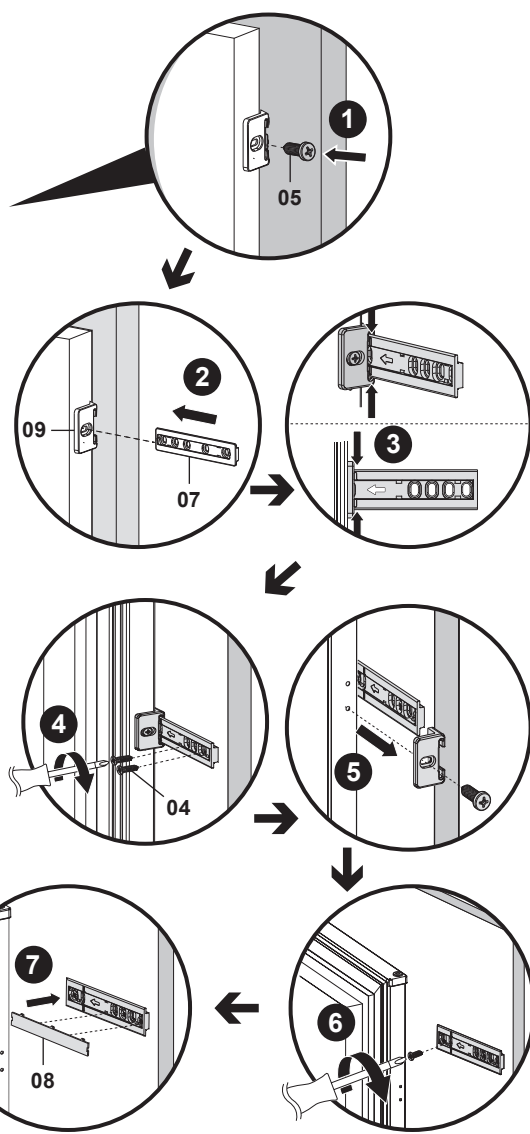

**EN IMPORTANT:** If your decorative doors are Shaker style with a thinner centre panel, do not use any screws in this section of the door. Use two screws 04 in the thicker section of the door only.

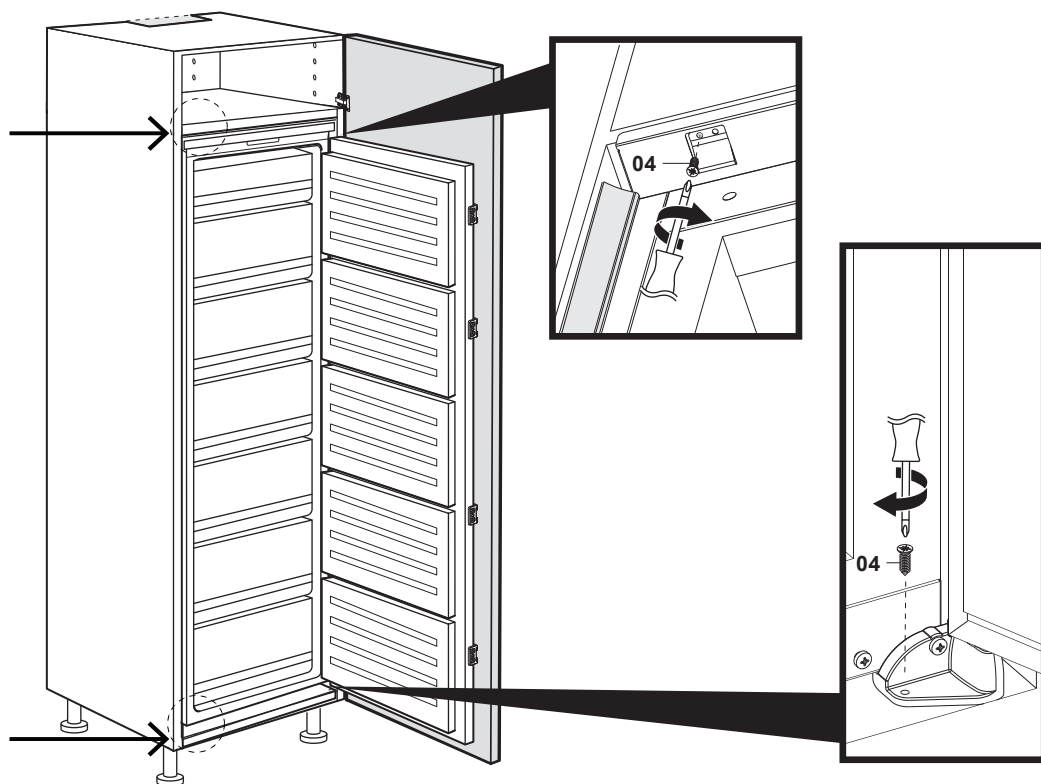

- EN**
- Secure the top panel of the appliance to the underside of the shelf using 04. x2.
  - Secure the two feet to the base of the cabinet using 04. x2.

Before you start

 **IMPORTANT:** TO ALLOW THE COOLANT TO SETTLE, LEAVE THE APPLIANCE IN ITS FINAL LOCATION FOR AT LEAST THREE HOURS BEFORE TURNING ON THE POWER.

The normal operating temperature for the freezer compartment is between -24 °C and -16 °C.

Try to keep the door open for the shortest time possible to avoid increasing the compartment temperatures which results in the compressor using more energy.

Control panel

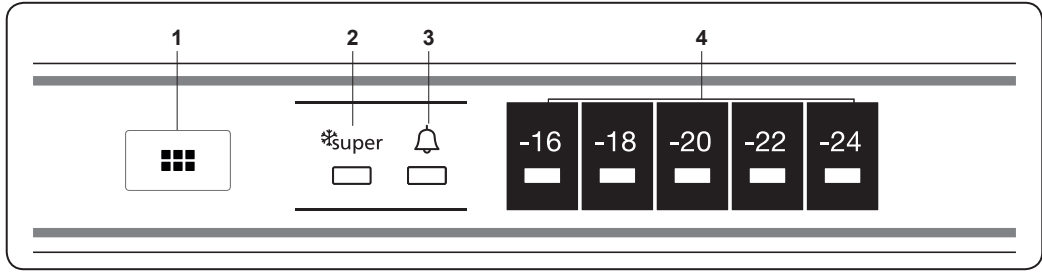

- |                         |  |
|-------------------------|--|
| 1. Thermostat button    | • Press this control to adjust the freezer temperature.  |
| 2. Super freeze control | • For rapidly freezing foods. This is recommended to use for a maximum of two hours only to avoid excessive energy usage and will automatically cancel after 30 hours use. |
| 3. Alarm LED            | • This LED will illuminate in the event of a problem with the appliance. Please contact the Customer Helpline at the end of this manual for assistance.                    |
| 4. Freezer temperature  | • As the thermostat button is pressed, the display will cycle through the temperature options of -16 °C to -24 °C and then back to super.                                  |

Freezer Storage Advice

- Store fresh food in airtight boxes or wrap in bags or foil which are suitable for freezing.
- Do not allow frozen food to come into direct contact with unfrozen food.
- Pre-frozen food must be placed in the freezer as quickly as possible after purchasing.
- To prevent frost damage to fresh vegetables or fruits ensure they have been prepared correctly in advance. For example, blanch and shock vegetables and then dry thoroughly.
- You must always follow the storage guidelines printed on all food packaging. These are the maximum freezer storage times recommended at -18 °C:
  - Ice Cream 1-2 months
  - Fish & Pork 3-6 months
  - Bread & Cheese 3-6 months
  - Meat & Poultry 9-12 months
  - Fruit & Vegetables 9-12 months





**CAUTION:** DISCONNECT THE APPLIANCE FROM THE POWER SUPPLY BEFORE CLEANING.

### Internal Cleaning

- Do not pour water over the appliance.
- The cavity should be cleaned periodically using a solution of bicarbonate of soda and lukewarm water (5 ml to 0.5 litre of water).
- Clean the accessories separately with soap and water. Do not put them in the dishwasher.
- Do not use abrasive products, detergents or soaps.
- After washing, rinse with clean water and dry carefully.
- When you have finished cleaning reconnect the plug with dry hands.

### External Cleaning

- Wash the outer cabinet with warm soapy water. Do NOT use abrasive products.
- There are sharp edges on the underside of the product so care should be taken when cleaning.
- Once or twice a year dust the rear of the appliance and the compressor at the back of the appliance, with a brush or vacuum cleaner, as an accumulation of dust will affect the performance of the appliance and cause increased energy consumption.

### When the appliance is not in use

When the appliance is not in use for long periods, disconnect from the electricity supply, empty all of the food and clean the inside. Leave the door open to prevent the build-up of odours.

### Defrosting

**NOTE:** Care must be taken when performing the following procedure.

The appliance is frost free, so there shouldn't be any requirement to defrost the freezer. However, in the unlikely event the appliance does need defrosting please follow the below steps:

- Two hours before defrosting is due to start, turn the thermostat up to maximum (-24°C) to ensure the food is as cold as possible. Remove and store in cool bags with ice blocks or another fridge as necessary.
- Protect the floor and fridge compartments with towels and containers to catch the ice as it melts.
- Switch off the appliance at the socket outlet and pull out the mains plug.
- Remove all drawers and shelves and leave the doors open.
- Never use hairdryers, electrical heaters, sharp knives or tools for defrosting.
- When the ice has melted, clean and dry the interior. Wipe up any spillages that may have occurred.
- Replace the mains plug, turn the appliance back on and return the food from storage.

## **Replacing a faulty bulb**

The LED bulb inside the appliance cannot be replaced by the consumer. If the bulb fails please contact the Customer Service helpline for your country at the end of this manual to arrange an engineer visit.

---

**Manufacturer:**

**UK Manufacturer:**

Kingfisher International Products Limited,  
1 Paddington Square, London, W2 1GG,  
United Kingdom

**EU Manufacturer:**

Kingfisher International Products B.V.,  
Rapenburgerstraat 175E,  
1011 VM Amsterdam,  
The Netherlands

**EN** [www.diy.com](http://www.diy.com)

[www.screwfix.com](http://www.screwfix.com)

[www.screwfix.ie](http://www.screwfix.ie)

Customer Helpline (Freephone)

UK 0330 678 3077 [uk@kingfisherservice.com](mailto:uk@kingfisherservice.com)

Eire 1800 365 800 [eire@kingfisherservice.com](mailto:eire@kingfisherservice.com)

**To view instruction manuals online,  
visit [www.kingfisher.com/products](http://www.kingfisher.com/products)**