

# TOWER

over 100 YEARS of quality



# CAVALETTO

## 12 INCH METAL DESK FAN

T611000

Applicable to  
all colour variants

**3**  
SPEED  
SETTINGS

**70°**  
AUTOMATIC  
OSCILLATION

**35W HIGH  
POWERED  
COOLING  
CIRCULATION**

**STYLISH  
METAL  
FINISH**



**Call us first, we can help.**

With advice, spares and returns.

Visit our website: **Call: +44 (0)333 220 6066**  
**towerhousewares.co.uk** (8.30am to 6.00pm Monday-Friday)

**3\***  
YEAR  
GUARANTEE

SAFETY AND INSTRUCTION MANUAL

PLEASE READ CAREFULLY

\*Subject to registering your Extended Guarantee online at [www.towerhousewares.co.uk](http://www.towerhousewares.co.uk).

## Specifications:

**This box contains:**  
Instruction Manual  
Fan Unit

1. Front Grille
2. Fan Blade
3. Rear Grille
4. Locking Screw
5. Locking Screw Nut

6. Grille Securing Clasps
7. Grille Locking Screws
8. Shaft
9. Speed Control Knob
10. Oscillation Knob
11. Motor Housing
12. Tilt Locking Mechanism
13. Base Fixing Screw

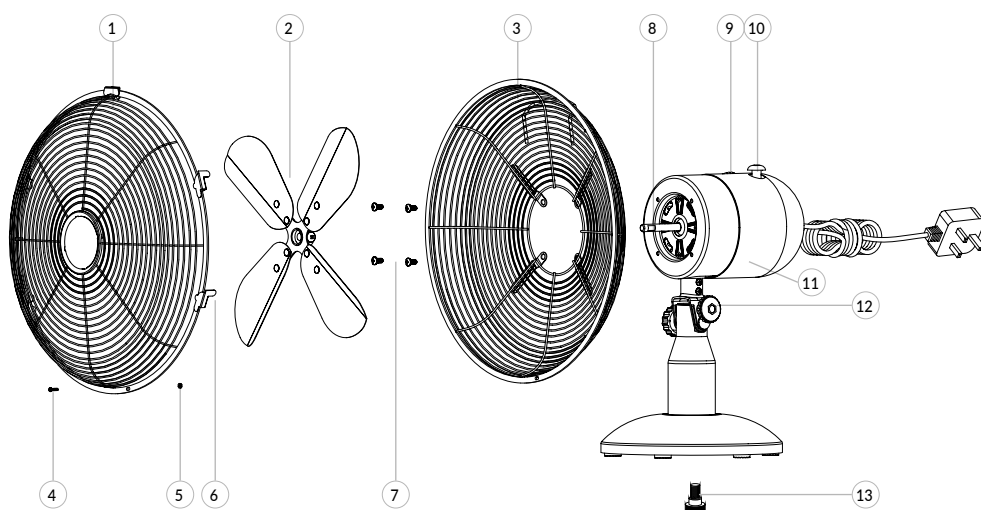

## Technical Data:

Description:	12 Inch Desk Fan
Model:	T611000 applicable to all colour variants
Rated Voltage:	220-240V~
Frequency:	50-60Hz
Power consumption:	35W



#### DISPOSAL OF THE UNIT

Appliances bearing the symbol shown here may not be disposed of in domestic rubbish. You are required to dispose of old electrical and electronic appliances like this separately.

Please visit [www.recycle-more.co.uk](http://www.recycle-more.co.uk) or [www.recyclenow.co.uk](http://www.recyclenow.co.uk) for access to information about the recycling of electrical items.

Please visit [www.weeeireland.ie](http://www.weeeireland.ie) for access to information about the recycling of electrical items purchased in Ireland.

The WEEE directive, introduced in August 2006, states that all electrical items must be recycled, rather than taken to landfill.

Please arrange to take this appliance to your local Civic Amenity site for recycling, once it has reached the end of its life.



## Important Safety Information:

Please read these notes carefully BEFORE using your Tower appliance

- Check that the voltage of the main circuit corresponds with the rating of the appliance before operating.
- Please ensure that the appliance is used on a stable, level, and heat resistant surface.
- DO NOT immerse cords, plugs or any part of the appliance in water or any other liquid.
- DO NOT leave the appliance unattended while it is operating.
- Close supervision is necessary when any appliance is used by or near children or pets.
- This appliance can be used by children aged from 8 years and above and persons with reduced physical, sensory or mental capabilities or lack of experience and knowledge if they have been given supervision or instruction concerning use of the appliance in a safe way and understand the hazards involved.
- Children shall not play with the appliance.
- Cleaning and user maintenance shall not be made by children without supervision.

- Switch off at the wall socket then remove the plug from the socket when not in use or before cleaning.
- If the supply cord or appliance is damaged, stop using the appliance immediately and seek advice from the manufacturer or its service agent or a similarly qualified person.
- DO NOT let the cord hang over the edge of a table or counter or let it come into contact with any hot surfaces.
- The use of accessory attachments is not recommended by the appliance manufacturer apart from those supplied with this product. DO NOT use extension cords with the appliance.
- DO NOT pull the plug out by the cord as this may damage the plug and/or the cable.
- DO NOT use this product for anything other than its intended use.
- This appliance is for household use only.
- DO NOT carry the appliance by the power cord.
- DO NOT use the appliance outdoors.
- DO NOT run cord under carpeting. DO NOT cover cord with throw rugs, runners or the like. Arrange cord away from traffic area to avoid anyone from tripping over.
- DO NOT insert or allow foreign objects to enter any ventilation opening as this may cause an electric shock, fire, or damage to an individual or a property.
- To prevent overload and blown fuses, be sure that no other appliance is plugged into the same outlet (receptacle) or into another outlet (receptacle) wired into the same circuit.
- We DO NOT recommend use of an extension cord as it may overheat and cause a risk of fire. However, if you have to use an extension cord, the cord should be No. 14 AWG minimum size and rated not less than 1875 watts, and has to be used only for supplying power to this fan.

- Never insert your fingers, pencils or other objects through the cage during operation.
- The fan should be set up on a stable and level surface to avoid it being knocked over.
- DO NOT expose the fan to excessive heat or humidity as this can cause damage to the electrical components.
- The fan should be kept out of the reach of children.
- In the unlikely event the appliance develops a fault, stop using it immediately and seek advice from the Customer Support Team.
- In the unlikely event the appliance develops a fault, stop using it immediately and seek advice from the Customer Support Team.

### Before First Use:

Read all instructions and safety information carefully before first use. Please retain this information for future reference.

1. Remove the appliance from the packaging and check for any visible signs of damage to the unit and cable.
2. Assemble as instructed.
3. Your appliance is now ready for normal use.
4. Dispose of the packaging in a responsible manner.
5. Place the unit on a firm and level surface.

### Assembly of your desk fan:

1. Turn the fan upside down and remove the base fixing screw from the pole of the main body by turning it in an anticlockwise direction.
1. Place the base against the pole and align the hole on the base and pole then screw the base fixing screw back into place.
2. Remove the 4 grille locking screws from the main body.

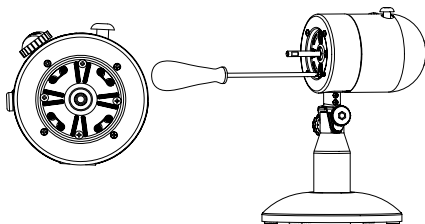

3. Set the rear grille in the proper position with the handle up. Let the four screws go through the rear guard hole and tighten (but do not over tighten).

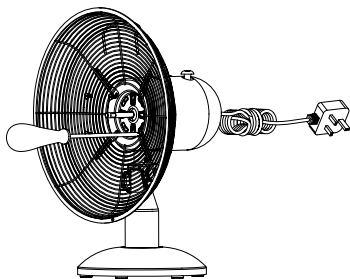

4. Discard the plastic sleeve on the shaft. Install the blade onto the shaft until the retaining pin fits into the notch on the blade, then use the screw to fix it and tighten (but do not over tighten).

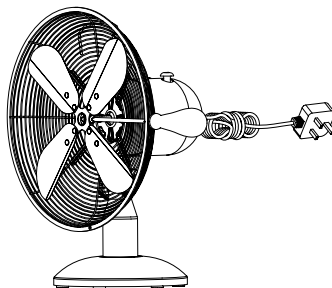

5. Open the 4 grille securing clasps on the front grille then mount onto the rear grille by placing the top hook clip over the top of the rear grille. Close the grille securing clasps then insert the locking screw through the hole at the bottom of the front and rear grille then place the locking nut onto the back of the locking screw and tighten it in a clockwise direction to secure the two grilles together.

**Note:** When first inserting the locking screw into the corresponding holes on the rim of the fan grille, only tighten it loosely. Ensure you have secured the front safety grille as detailed above before tightening this screw in all the way; otherwise, the front safety grille may not be correctly installed.

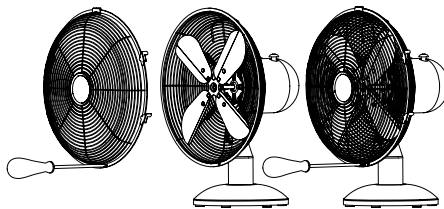

### Adjustable tilting head:

Use the top two screws to adjust the angle of the fan head.

Loosen the screws to move the head to the desired angle, and tighten them to lock into place.

**CAUTION!** Do not use the fan when the front guard is not locked into place.

**Note:** Make sure that the fan is on a level surface and away from any liquids. Oscillating the fan will create a more uniform cooling effect in the room.

#### Using your appliance:

Choose one of the following 3 speeds using the speed dial.

- 0 Stop
- I Low
- II Medium
- III High

#### Oscillation:

Push down the oscillation button to activate the oscillation function. Pull the button back up to stop the oscillation.

#### Cleaning and care:

Before cleaning always switch off the appliance and remove the plug from the electrical socket.

To clean the outside of the fan, wipe the exterior with a soft, damp cloth.

Never use an abrasive cleaner.

When not in use, store the fan (preferably in its original box) in a cool, clean and dry location.

#### Cleaning the fan blades:

Remove the front guard by unclipping the locking clips located around the circumference of the guard. The top lock does not unclip.

Use a small spanner to unscrew the nut and bolt that holds the bottom of the front guard to the back guard.

With both hands, pull the front guard downwards and away.

Clean the fan blades with a soft, damp cloth.

Slide the front guard back into place, so it fits into the top lock clip. Clip all the locks back into place and screw the nut and bolt back in.

#### WARNING:

DO NOT immerse any electrical part of the appliance in water such as motor units or plugs.

Please see cleaning section for further instructions.

Model Identifier(s): T611000 applicable to all colour variants			
Item	Symbol	Value	Unit
Maximum fan flow rate	F	36.68	m <sup>3</sup> /min
Fan Power input	P	35.29	W
Service value	SV	1.04	(m <sup>3</sup> /min)/W
Standby power consumption	PSB	0.00	W
Fan sound power level	LWA	60.07	dB(A)
Maximum air velocity	C	2.47	m/sec
Seasonal electricity consumption	Q	11.29	kWh/a
Measurement standard for service value	IEC 60879:1986+ (corr. 1992)		
Contact Details:	RKW LTD, Sutton House, Berry Hill Industrial Estate, Berry Hill Road, Stoke-on-Trent, ST4 2NL		

# TOWER

over 100 YEARS of quality



# CAVALETTO

## thank you!

We hope you enjoy your appliance for many years.

This product is guaranteed for 12 months from the date of original purchase. If any defect arises due to faulty materials or workmanship, the faulty products must be returned to the place of purchase.

Refund or replacement is at the discretion of the retailer.

### The Following Conditions Apply:

The product must be returned to the retailer with proof of purchase or a receipt. The product must be installed and used in accordance with the instructions contained in this instruction guide.

It must be used only for domestic purposes.

It does not cover wear and tear, damage, misuse or consumable parts.

Tower has limited liability for incidental or consequential loss or damage.

This guarantee is valid in the UK and Eire only.

The standard one year guarantee is only extended to the maximum available for each particular product upon registration of the product within 28 days of purchase. If you do not register the product with us within the 28 day period, your product is guaranteed for 1 year only.

To validate your extended warranty, please visit  
[www.towerhousewares.co.uk](http://www.towerhousewares.co.uk) and register with us online.

Please note that length of extended warranty offered is dependent on product type and that each qualifying product needs to be registered individually in order to extend its warranty past the standard 1 year.

Extended warranty is only valid with proof of purchase or receipt.

Your warranty becomes void should you decide to use non Tower spare parts.

Spare parts can be purchased from

[www.towerhousewares.co.uk](http://www.towerhousewares.co.uk)

Should you have a problem with your appliance, or need any spare parts, please call our Customer Support Team on:

**+44 (0) 333 220 6066**

